

U9

Intel LGA 20XX

INSTALLATION GUIDE

安装指南

Step 2:
Apply the thermal grease / 涂导热膏

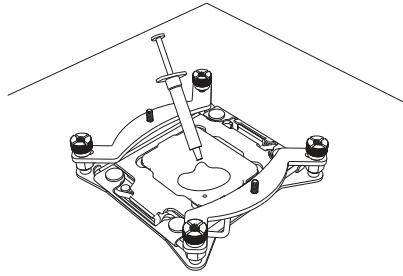



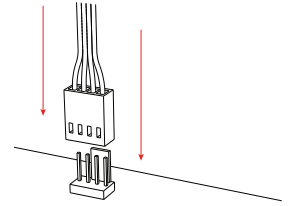

Step 5:
Connect the 4Pin fan connector to the motherboard / 连接4 Pin风扇接头至主板

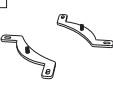
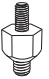

Intel Components & Tool/Intel 安装所需零件及工具

Intel LGA 20XX Installation

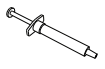
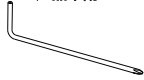
1		2		3	 x 2
4		5	 x 4	6	 x 4
7		8	*Not Included/ 产品未附 		

1. Cooler / 散热器
2. Fan / 风扇
3. Fan Clip / 风扇卡扣
4. Intel Retention Bracket Pair / Intel脚架组
5. 20XX screw/20XX螺丝
6. Thumb screw / 手拧螺丝
7. Thermal grease / 导热膏
8. Phillips Head Screw Driver (Not Included) / 十字螺丝刀 (产品未附, 需自行准备)

Step 3:
Remove the protector and install the cooler onto the motherboard / 移除保护贴, 安装散热器至主板

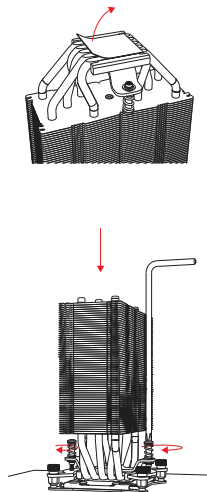

Intel LGA 20XX Installation

Intel LGA 20XX Installation

Step 1:
Install the 20XX screw, Intel bracket, and the thumb screw / 安装20XX螺丝、Intel脚架和手拧螺丝

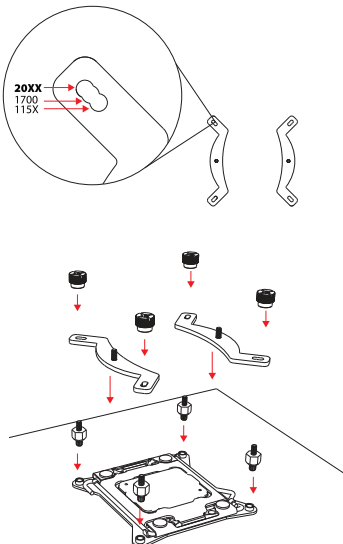

Step 4:
Use the fan clip, install the fan onto the cooler / 使用风扇卡扣, 安装风扇至散热器

